



Smart HEPA Air Purifier TA-300 User Manual

1. Important Safety Instructions



Read these instructions carefully and retain them for future use. If this product is passed to a third party, then these instructions must be included.

When using electrical appliances, basic safety precautions should always be followed to reduce the risk of fire, electric shock, and/or injury to persons including the following:

- ▶ This appliance can be used by children aged from 8 years and above and persons with reduced physical, sensory or mental capabilities or lack of experience and knowledge if they have been given supervision or instruction concerning use of the appliance in a safe way and understand the hazards involved. Children shall not play with the appliance. Cleaning and user maintenance shall not be made by children without supervision.
- ▶ If the supply cord is damaged, it must be replaced by the manufacturer, its service agent or similarly qualified persons in order to avoid a hazard.
- ▶ Prior to cleaning or other maintenance, the appliance must be disconnected from the supply mains.
- ▶ Keep children under close supervision when using the appliance in their proximity.
- ▶ Always operate the appliance on a level, stable, clean and dry surface.
- ▶ Never use a damaged appliance or after it was dropped! Disconnect the appliance from the outlet and contact the retailers service centre for examination and repair.
- ▶ Do not attempt to repair the appliance yourself. In case of malfunction, contact the qualified repair centre.
- ▶ Keep the appliance 1.5 metres away from where oxygen is being administered.

- ▶ To avoid damaging the power cord, do not squash, bend or chafe it on sharp edges. Keep the power cord and appliance away from hot surfaces and open flames.
- ▶ Place the power cord in such a way that unintentional pulling or tripping over it is not possible.
- ▶ If an extension cord is used, its rating needs to be suitable for the power consumed by the appliance.
- ▶ Do not operate the appliance with wet hands or while standing on a wet floor. Do not touch the plug with wet hands.
- ▶ Do not open the appliance housing. Do not insert any foreign objects into the inside of the appliance.
- ▶ Do not pull the plug out of the outlet by the power cord. Always pull on the plug itself.
- ▶ Prevent foreign objects from entering the air inlets/ outlets.
- ▶ Disconnect the plug from the outlet when not in use, before cleaning and / or before changing attachments.
- ▶ Always switch the appliance off before disconnecting the plug from the outlet.

2. Intended Use

- ▶ This product is intended to improve the air quality and eliminate pollutants.
- ▶ This product is intended for household use only.
- ▶ This product is intended to be used in dry indoor areas only.

3. Product Description

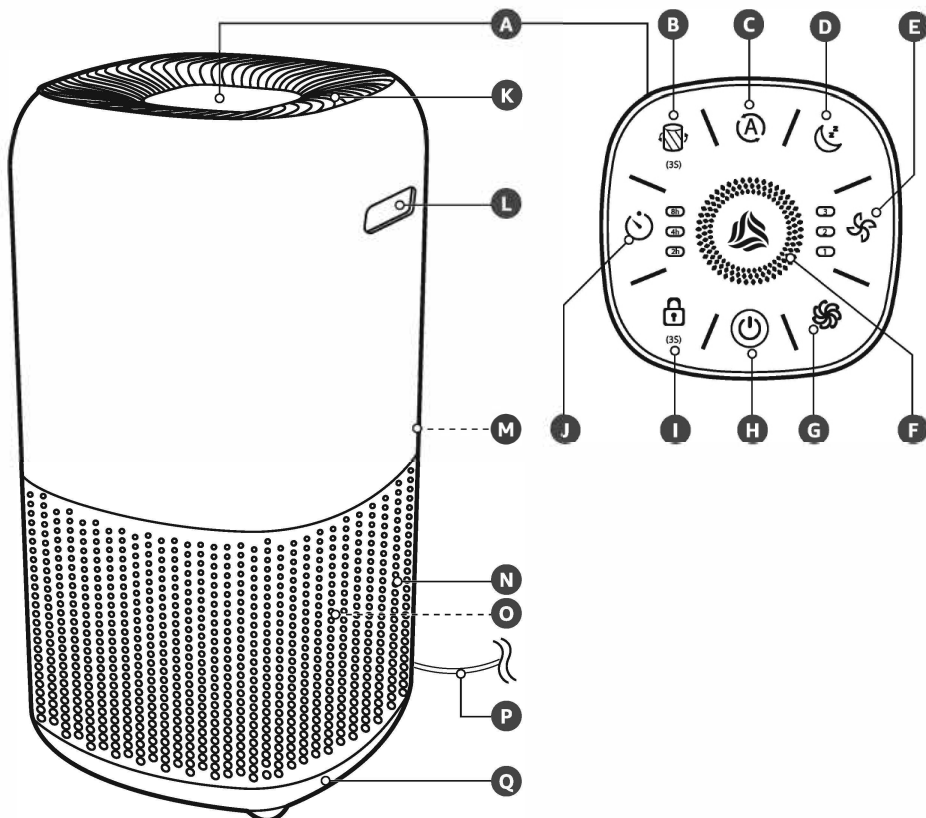

- | | |
|---|---|
| A Control panel | J Timer button with indicator |
| B Filter replacement button with indicator | K Air outlet |
| C Auto mode button with indicator | L Handle (both sides) |
| D Sleep mode button with indicator | M Air quality sensors with cover |
| E Fan speed button with indicator | N Air inlet |
| F Air quality indicator | O Air filter |
| G Turbo button with indicator | P Power cord with plug |
| H On/off button with indicator | Q Base cover |
| I Lock button with indicator | |

4. Before First Use

⚠ DANGER Risk of suffocation!

Keep any packaging materials away from children and pets – these materials are a potential source of danger, e.g. suffocation.

⚠ CAUTION Risk of damage!

Before first use, remove the film packaging from the air filter (O) and peel off the film protector from the control panel (A).

4.1 Removing the air filter (O) packaging

1. Remove the air filter (O) from the product (refer to 6.3 Cleaning the air filter chapter).
2. Remove the air filter (O) packaging.
3. Reinstall the air filter (O).

4.2 Positioning

- ▶ Ensure there is a clearance of 1 foot around the product.
- ▶ Ensure there are no objects obstructing the air inlet (N) or air outlet (K).

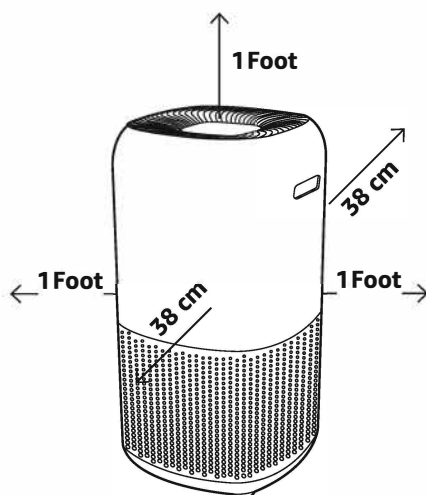

4.3 General instructions

- ▶ Remove all the remaining packing materials.
- ▶ Remove and review all components before use.
- ▶ Check the product for transport damages.
- ▶ Before connecting the product to the power supply, check that the power supply voltage and current rating corresponds with the power supply details shown on the product rating label.

5. Operation

5.1 Switching on/off

NOTICE If not unplugged, the product remembers the previous mode setting after switching on.

NOTICE After plugging in, the product beeps and the control panel (A) blinks.

- ▶ To switch on the product, press the on/off button (H). The product beeps and the on/off button's indicator (H) lights up red. The air quality indicator (F) lights up red, and then changes the color according to air quality (refer to 5.4 Auto mode chapter).
- ▶ To switch off the product, press the on/off button (H) again. The product beeps and the on/off button's indicator (H) goes off.

5.2 Setting the fan speed

To set the fan speed, press the fan speed button (E) repeatedly. Toggle between:

Fan speed indicator (E)	Speed mode
1	Slow
2	Medium
3	Fast

5.3 Turbo mode

The turbo mode is the fastest fan working setting. Use this mode for quick air pollutants and odor cleaning.

- ▶ To switch on the turbo mode, press the turbo button (G). The turbo indicator (G) lights up.
- ▶ To switch off the turbo mode, press any other mode's button. Turbo indicator (G) goes off. Other mode's indicator lights up.

5.4 Auto mode

Auto mode (C) adjusts the fan speed automatically according to the current air quality level. Air quality indicator (F) represents:

Air quality indicator (F)	Air quality level	Speed mode
Blue	Good	1 (slow)
Orange	Moderate	2 (medium)
Red	Poor	3 (fast)

5.5 Setting the timer

Set the timer to enable an automatic switch-off.

NOTICE The fan speed can be adjusted when the timer is on.

- ▶ To set the timer, press the timer button (J) repeatedly. Toggle between:

Timer indicator (J)	Setting
2h	2 hours
4h	4 hours
8h	8 hours
Timer indicator (J) off	Timer off

5.6 Sleep mode

Sleep mode enables a silent product operation at night. The fan speed slows down and the indicators go off.

- ▶ To switch on the sleep mode, press the sleep mode button (D). The sleep mode indicator (D) lights up. Other indicators go off (except for the filter replacement indicator (B)).
- ▶ To switch off the sleep mode, press any other mode's button twice. The sleep mode indicator (D) goes off. Other mode's indicator lights up.

5.7 Lock mode

Lock mode allows to lock all buttons. This helps to prevent accidental setting change by e.g. a child.

NOTICE Once in the lock mode, the product beeps and lock mode indicator (I) blinks 3 times after pressing any button.

- ▶ To switch on the lock mode, press and hold the lock button (I) for 3 seconds. The lock indicator (I) lights up.
- ▶ To switch off the lock mode, press and hold the lock button (I) for 3 seconds again. The lock indicator (I) goes off.

5.8 Filter replacement indicator (B)

NOTICE Clean or replace the air filter (O) immediately once the filter replacement indicator (B) lights up.

Filter replacement indicator (B) lights up when the air filter (O) needs to be cleaned or replaced.

- ▶ Clean the air filter (O) (refer to 6.3 Cleaning the air filter chapter).
- ▶ Press and hold the filter replacement button (B) for 3 seconds to reset the air filter. The product beeps and the filter replacement button (B) blinks 3 times.
- ▶ If the air filter replacement indicator (B) lights up again, replace the air filter (O) (refer to 6.4 Replacing the air filter chapter).

6. Cleaning and Maintenance

⚠ WARNING Risk of electric shock!

- ▶ To prevent electric shock, unplug the product before cleaning.
- ▶ During cleaning do not immerse the electrical parts of the product in water or other liquids. Never hold the product under running water.

6.1 Cleaning the product

- ▶ To clean the product, wipe with a soft, slightly damp cloth.
- ▶ Wipe the product dry after cleaning.
- ▶ Never use corrosive detergents, wire brushes, abrasive scourers, metal or sharp utensils to clean the product.

6.2 Cleaning the air quality sensors

For optimal functioning, clean the air quality sensors every 2 months. Clean the air quality sensors more frequently if using the product in dusty or humid environment.

- ▶ Use a flat screwdriver to open the air quality sensors cover (M) (Fig. 1).

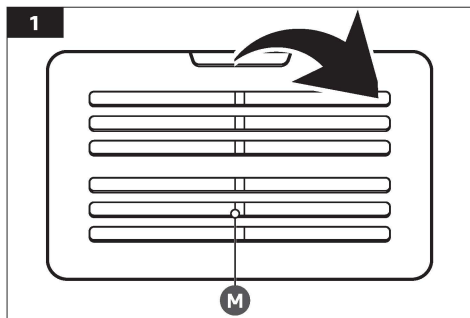

- ▶ Use a soft brush to clean the air quality sensors cover (M) (Fig. 2).

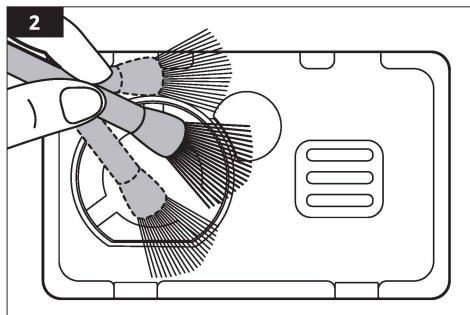

- ▶ Close the air sensors quality's cover (M).

6.3 Cleaning the air filter (O)

CAUTION Risk of damage!

Clean the outer side of the air filter (O) only.

For optimal functioning clean the air filter (O) every 2 weeks.

1. Unplug the power cord (P) from the socket outlet.
2. Use the handles (L) to put the product upside down on a soft surface (Fig. 3).
3. Ensure the **PULL OUT** indicator on the base cover (Q) is facing you (Fig. 3).
4. Pull out the base cover (Q) from the product (Fig. 3).
5. Pull out the air filter (O) from the product (Fig. 4).

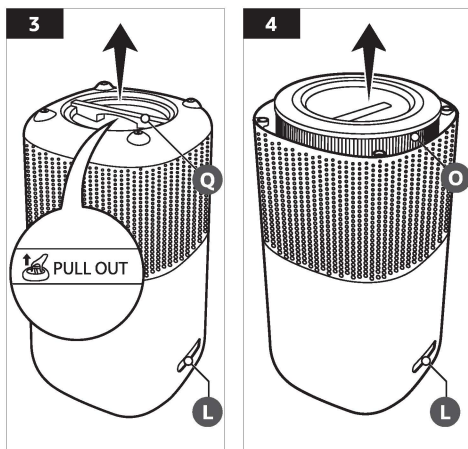

6. Use a vacuum cleaner to remove the dirt from the outer side of the air filter (O) (Fig. 5).

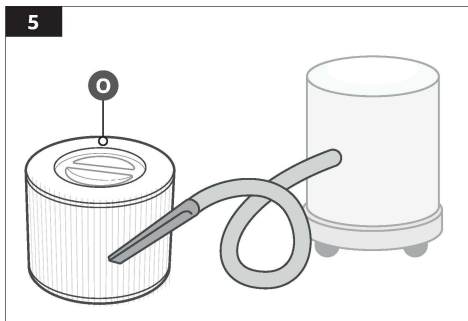

7. Use a vacuum cleaner to remove the dirt from the air inlet (N) cover (Fig. 6).

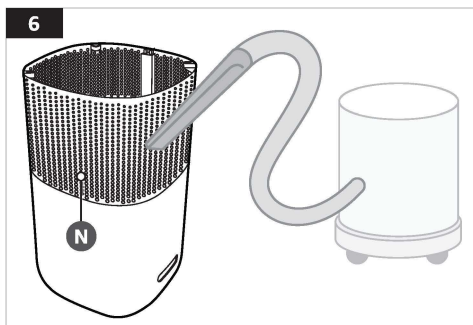

8. Reinstall the air filter (O) (Fig. 7).
9. Ensure the **PULL OUT** indicator on the base cover (Q) is facing you. Close the base cover (Q) (Fig. 8).

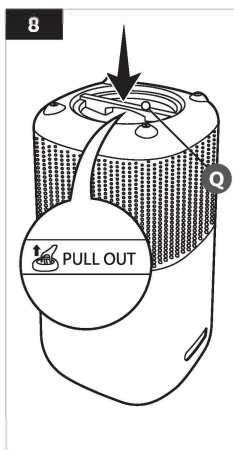
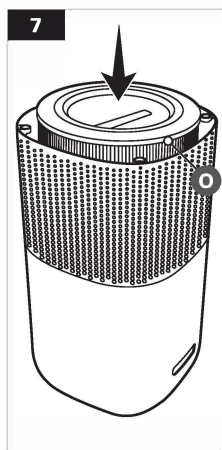

10. Switch on the product.
11. If the filter replacement indicator (B) lights up, press and hold the filter replacement button (B) for 3 seconds to reset the filter. The product beeps and the filter replacement button (B) blinks 3 times.
12. If the air filter replacement indicator (B) lights up again, replace the air filter (O) (refer to 6.4 Replacing the air filter chapter).

6.4 Replacing the air filter (O)

NOTICE Filter must be checked for function and wear at regular intervals.

Replace the air filter (O):

- ▶ In every 6-8 months depending on the use and environment.
- ▶ If you experience increased operating noise, decreased airflow or increased odor level.

NOTICE Depending on the environment (level of air contamination), and the selected operation mode, the filter may degrade considerably early. Look for early signs that filter might need replacement.

1. Unplug the power cord (P) from the socket outlet.
2. Use the handles (L) to put the product upside down on a soft surface (Fig. 3).
3. Ensure the **PULL OUT** indicator on the base cover (Q) is facing you (Fig. 3).
4. Pull out the base cover (Q) from the product (Fig. 3).
5. Pull out the air filter (O) from the product (Fig. 4).
6. Install the new filter (O) (Fig. 7).
7. Ensure the **PULL OUT** indicator on the base cover (Q) is facing you. Close the base cover (Q) (Fig. 8).
8. Switch on the product.
9. Press and hold the filter replacement button (B) for 3 seconds to reset the air filter (O). The product beeps, the filter replacement indicator (B) blinks 3 times and goes off.

Description	Model number
Air filter (O)	TA300-RF

6.5 Storage

- ▶ Store the product in its original packaging in a dry area. Keep away from children and pets.
- ▶ Store the air filter (O) clean and sealed in a plastic bag.

6.6 Maintenance

1. Any other servicing than mentioned in this manual should be performed by a professional repair center.

7. Troubleshooting

Problem	Solution
The product does not switch on.	<ul style="list-style-type: none"> Check if the plug is connected to the socket outlet. Use voltage tester to verify if the socket outlet is powered. The air filter (O) and/or base cover (Q) is not properly installed. Refit the filter and/or base cover.
For UK only: Fuse in the plug is blown.	<ul style="list-style-type: none"> Use a flat screwdriver to open the fuse compartment cover. Remove the fuse and replace with the same type (3A, BS1363). Refit the cover.
The product makes noise.	<ul style="list-style-type: none"> Clean the air quality sensors. Ensure the product is placed on a stable, flat and level surface. Ensure the air filter's (O) film packaging is removed before first time use. Ensure there is no object placed closer than 12 inches from all sides nor above of the product. Clean the air inlets (N). Clean or replace the air filter (O). Ensure there is no foreign object obstructing the product's operation. The product may be damaged or a foreign object may be inside. Switch off the product and contact the qualified repair centre.
Filter replacement indicator lights up frequently.	<ul style="list-style-type: none"> Press and hold the filter replacement button (B) for 3 seconds to reset the air filter. If the air filter replacement button (B) lights up again, replace the air filter (O).
The airflow reduces significantly.	<ul style="list-style-type: none"> Ensure the air filter's (O) film packaging is removed before first time use. Clean the air filter (O). Replace the air filter (O) if cleaning does not solve the problem. Ensure there is no objects blocking the air outlet (K) and air inlet (N).
The product emits a strange smell.	<ul style="list-style-type: none"> Ensure the area is not in high humidity nor there are any essential oils being diffused. Clean or replace the air filter (O). Switch off the product and contact the qualified repair centre.
Product beeps repeatedly after switching on.	<ul style="list-style-type: none"> Switch off the product and contact the qualified repair centre.

8. Filter Disposal

Dispose the filter accordingly to the local regulations at specified disposal facilities. The filter can be disposed together with household rubbish.

9. Disposal



The Waste Electrical and Electronic Equipment (WEEE) Directive aims to minimise the impact of electrical and electronic goods on the environment, by increasing re-use and recycling and by reducing the amount of WEEE going to landfill. The symbol on this product or its packaging signifies that this product must be disposed separately from ordinary household wastes at its end of life. Be aware that this is your responsibility to dispose of electronic equipment at recycling centres in order to conserve natural resources. Each country should have its collection centres for electrical and electronic equipment recycling. For information about your recycling drop off area, please contact your related electrical and electronic equipment waste management authority, your local city office, or your household waste disposal service.

10. Specifications

Model number	TA-300
Rated voltage	220-240 V~, 50-60 Hz
Power consumption	35 W
Power consumption in off mode	≤ 0.5 W
Protection class	Class II
Filter type	99.97% True HEPA 4-stage filter
Net weight	approx. <15 lbs
Dimensions (W x H x D)	approx. 11"(\varnothing)x11"(W)x20.5"(H)



www.TrustedAir.com

MADE IN CHINA